

Leprechaun[®]

2005 Class C Motorhomes By Coachmen



Coachmen[®]

Recreational Vehicles

Leader to the Great Outdoors[®]



Leprechaun... Leading the way

The Leprechaun® Class C Motorhome by Coachmen is one of the most recognized Class C names in the nation and Coachmen RV is one of the top selling brand name Class C's in America.

The Leprechaun is the cross road where luxury and affordability meet. Spacious floorplans and a basement floor design provide the foundation for the ultimate RV'ing experience. Sit back and enjoy all of the luxury and user friendly standard features that the Leprechaun delivers such as: oak edged countertops, night shades, water purifier with dedicated drinking faucet, glass shower door, laundry hamper and even reading lights over the sofa. There are also plenty of optional value added amenities designed to customize a Leprechaun for you.

For unparalleled comfort as you tour our great country, step up to Leprechaun...an American tradition and Leader to the Great Outdoors®.



(Leprechaun 314SS shown in Windsor Willow decor)

Decor Selections

Dazzling interiors feature skillfully coordinated upholstery and window treatments. Coachmen RV chooses only top-grade fabrics wear-dated as heavy-duty. These fabrics have been tested for durability beyond 15,000 double rubs (in and out action) to simulate heavy usage. An average chair in an American home is subjected to only 3,000 double rubs per year.

Fabric Key: A. Main B. Accent C. Bedspread

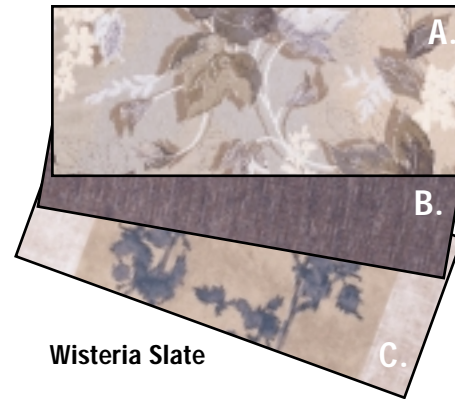

Wisteria Slate

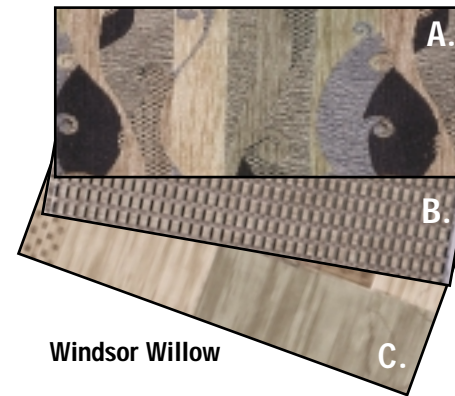

Windsor Willow

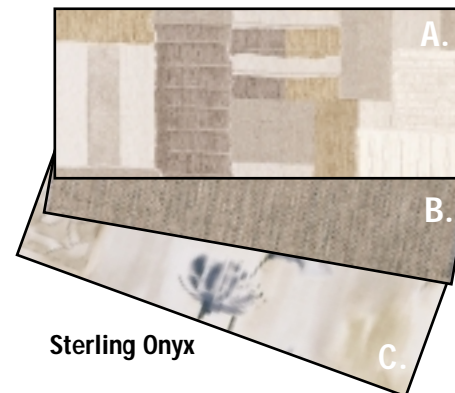

Sterling Onyx





The Leprechaun® 317KS is wonderfully featured with coach night shades, oak edged countertops and dinette table, ample cabinet storage, under sink utensil drawer; hardwood raised panel cabinet doors, pull out kitchen faucet, dedicated drinking faucet with purifier; optional convection microwave, directional reading lights over the sofa and designer sculpted carpet.

Leprechaun®

2005 Class C Motorhomes By Coachmen

Leprechaun® Features Galore

Check out the Leprechaun® Class C Motorhomes by Coachmen, and see the outstanding safety and value that is designed into every coach. These value packed coaches have features galore to enhance your RV'ing experience. It is sometimes the things you can't see like our **SureLine™** Electrical Harness and **Duratube™** LP lines that set us apart from the crowd, while other times it is the items that are easily visible. Take a minute to see just a few of the benefits that set us apart from the rest.



An optional **cabover entertainment center** offers a large 24" flatscreen television and DVD/VCR with plenty of additional storage space for your favorite videos and games. There is even enough space left for a generous overhead sleeping area.



The **deluxe overhead entertainment center** option features a 27" flatscreen television, DVD/VCR combo and large angled cabinet storage.



SAFETY FIRST!

While the law requires only enough seat belts to equal the number of sleeping positions, Coachmen puts seat belts at every fixed seating location. All of our seat belts meet the FMVSS standards as stated by the government.



SAFETY FIRST!

The optional **rear view camera** provides you with peace of mind and confidence as you back up. It is cleverly designed into the sun visor so that it takes up minimum space, yet it is large enough to give you a solid rear view.



Our standard **metal drawer guides** with glide wheels provide a friction free sliding drawer that is extremely durable. The drawer guides also act as a catch so that the drawer will not slide open during travel. Simply lift up and pull to open the drawers.



The **Flair-It™** compression fitting water line system uses radius bends to reduce the number of fittings used (approximately 56% less). Where connectors are needed, a compression fitting ensures a long term, tight seal.



SAFETY FIRST!

This optional **AM/FM stereo**, complete with cassette, CD player and built in weather band was specifically designed for use in RV's. The large, easy to use buttons and knobs let you keep your eyes on the road rather than on the radio.



A freshly brewed pot of coffee from the optional **spacesaver coffeemaker** is the perfect way to start your day.



Get a better picture and more channels with the optional satellite TV system.



The optional **hardwood freestanding dinette** features 4 designer chairs with a color coordinated fabric seat covering. (Select Models)



The optional **Grill-2-Go™** offers you the ultimate grilling tool. Lightweight, durable and extremely functional, this portable grill was designed to give you the flexibility to grill anywhere. (Most models)

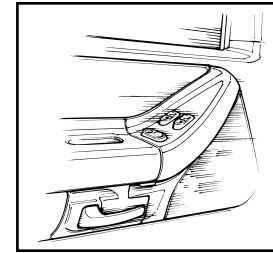

Standard **power windows and locks** are a comfort you don't have to go without. The large push button controls are conveniently located on the cockpit door arm rests for both the passenger and the driver.



Safety is paramount at Coachmen. All units come standard with an **LP leak detector, fire extinguisher, smoke detector and CO detector.**



A **trash can** is designed into the galley cabinets so that it is out of view while still being convenient to use. This is just another way that Coachmen pays attention to the details for your comfort.



The optional **Ride Rite® Air Assist Suspension** lets you adjust your rig for a smooth level ride. Air assist helps to prevent uneven tire wear and provides for safer travel.



The **Quick Cool™ air vent** lets you direct all cool air to a central location in the coach for maximum heat relief on those hot summer days.

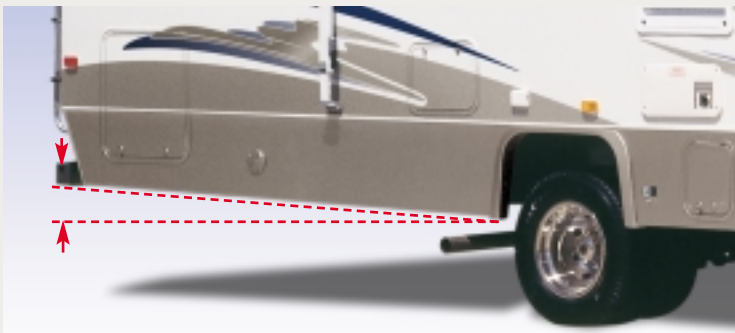

All Coachmen Class C Motorhomes feature a **raised departure angle** for greater ground clearance at the rear of the coach.



Skillfully designed **sink and plumbing placement** have allowed us to utilize the under sink space as a convenient **silverware/utensil drawer** that maximizes your interior storage space.



The handy **cockpit convenience area** features room for 2 large drinks, \$.05, \$.10, and \$.25 change holder, and extra miscellaneous storage for your essentials like sunglasses, road maps, and tissues.

Lepprechaun
2005 Class C Motorhomes By Coachmen

Leprechaun® Features Galore continued

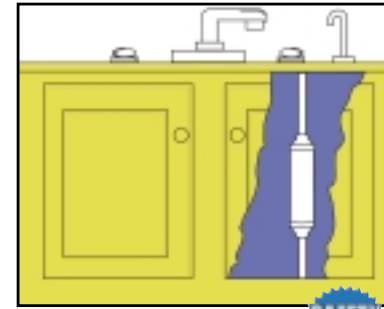

The water purifier significantly reduces the number of bacteria in the water, which results in safer, cleaner and better tasting water. There is even a dedicated drinking faucet standard on every Leprechaun.



Jalousie bedroom windows tilt out design allow them to be opened for ventilation even when the weather outside is less than favorable. Just because the rain keeps you inside, doesn't mean that you can't enjoy fresh outside air.



The double door refrigerator is designed for maximum storage capacity with door storage and a handy freezer shelf. A convenient refrigerator light is also standard for those midnight cravings.



The deluxe glass shower door provides an easy to clean surface that gives a sophisticated residential look to the bath area.



The optional rechargeable flashlight and rechargeable wet/dry vacuum have customized space designed right into the coach, so that they are out of the way, yet still within short reach when needed.



Built right into the bath cabinets is a large laundry hamper. The tilt out design makes this a very user friendly feature that conveniently hides your dirty clothes. (Select models have a laundry chute in the bedroom.)

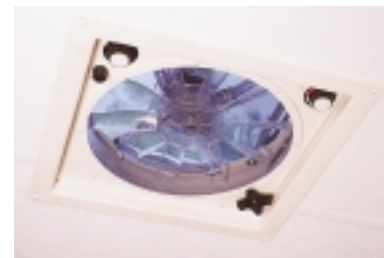

The optional variable speed Fantastic Fan™ is quiet, yet powerful enough to create ample air circulation throughout the coach.



Exterior storage has been utilized to its fullest with multiple locking storage door locations. Convenient door latches are also provided to hold the storage doors open while you grab your gear. Lighted compartments make it easy to see, any time of the day or night.



The kitchen faucet has a pull out sprayer that makes cleanup of taller pots and pans a cinch. There is also a purified drinking water faucet so that you can have great tasting and clean water any time.



Don't fumble around late at night looking for the light switch. Extra large toggle wall switches are conveniently located throughout the coach and can be flipped on/off with the palm of your hand.



The conveniently located hair dryer is a multi-functional option with its built in night light. The space saving hair dryer does not take up valuable countertop space as the wall mounted base holds it up and out of the way.

Ask your dealer about these Coachmen exclusive design features



Coachmen's **SureLine™ Electrical Harness** provides color coded wiring and specific wiring schematics for easy serviceability. High quality automotive electrical connectors and autoloam protective covering make for a reliable and durable harness. The wires are grouped together and neatly tucked into the framework under the coach, safe from road debris.



The Coachmen **Even Cool™ air conditioning system** is ducted through the crowned, vacuumbonded roof and utilizes AMOCO insulated ductwork with radiused corners to provide for maximum cooling efficiency.

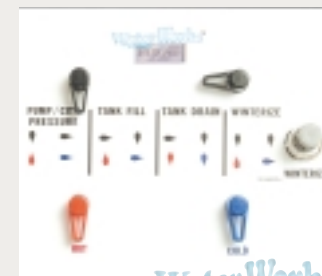

It doesn't have to be a weekend project figuring out how to fill, drain, or winterize your RV. Our easy to use **Water Works™ Utility Panel** with large dials, simply displays how to perform each function. No lengthy explanations or wordy booklet are necessary.

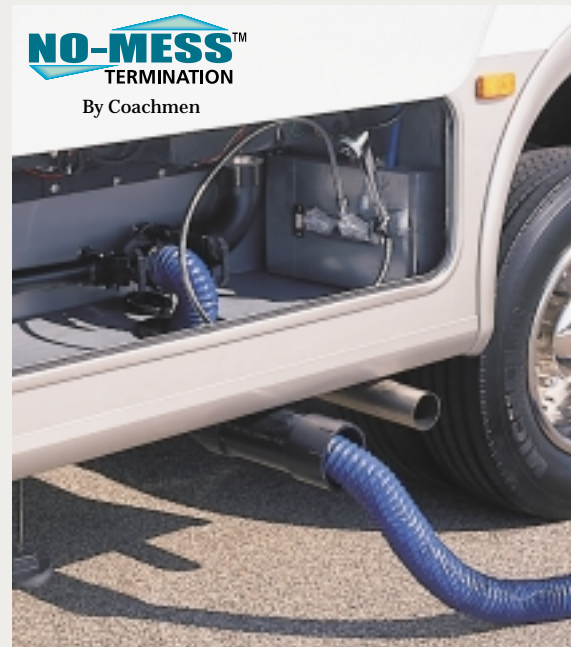

The Coachmen exclusive **No-Mess™ termination system** is an easy to swivel boom arm that provides a convenient storage location for the termination hose. Your storage bay stays cleaner and the hose can remain connected after use.



All Leprechaun® motorhomes feature **Alumicage™ construction**. Lightweight, corrosion resistant, aircraft grade aluminum is utilized throughout the roof and walls for superior strength and ultra light weight.



All Coachmen units utilize **Duratube™ full length copper LP lines** with double flared ends to ensure a tight seal and years of corrosion free use. Coachmen builds quality for the long haul.

Leprechaun®
 2005 Class C Motorhomes By Coachmen

Leprechaun® Floorplans

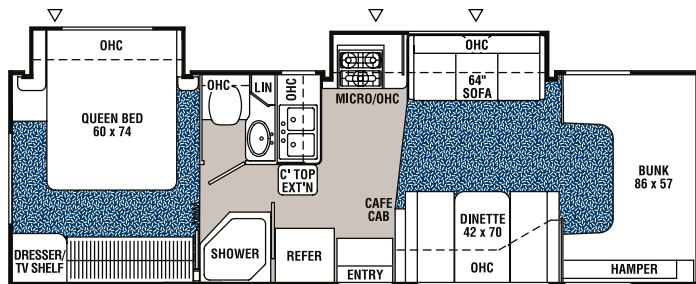

292DS
Available with options: A, B

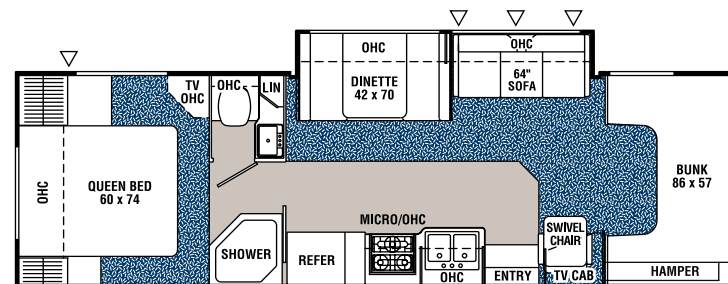

314SS
Available with option: A, B

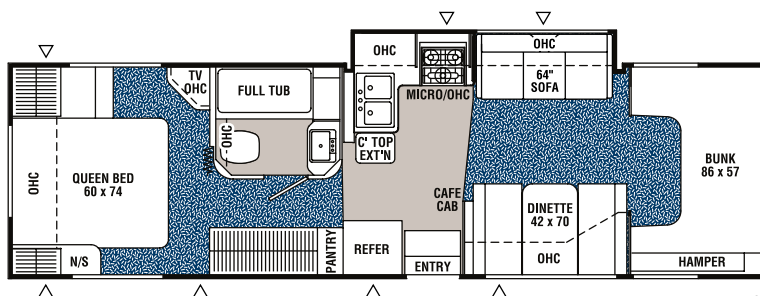

307KS
Available with options: A, B, C

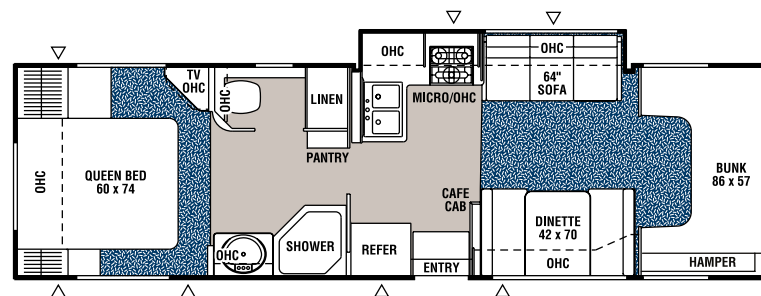

317KS
Available with options: A, B, C

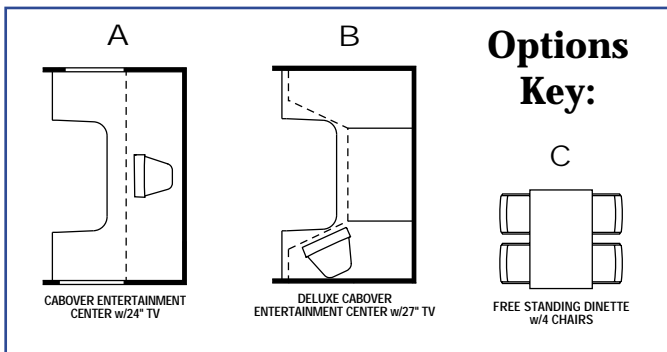

LIFE IN THE FAST LANE
NASCAR driver Mike Wallace makes a Coachmen RV motorhome his home on the road. The middle brother of auto racing's famed Wallace family, Mike is a veteran of NASCAR's racing circuit.

Specifications	292DS	307KS	314SS	317KS
Chassis	FORD	FORD	FORD	FORD
Chassis Model	E-45	E-45	E-45	E-45
Engine Size (liter)	6.8L	6.8L	6.8L	6.8L
Wheel Base	190"	208"	208"	208"
Rear Axle Ratio	4.63	4.63	4.63	4.63
Tire Size	(1)	(1)	(1)	(1)
GVWR (Pounds)	14,050	14,050	14,050	14,050
CW (Pounds)	11,240	11,333	11,198	11,525
GAWR Front (Pounds)	4,600	4,600	4,600	4,600
GAWR Rear (Pounds)	9,450	9,450	9,450	9,450
GCWR (Pounds)	20,000	20,000	20,000	20,000
Exterior Length	29'	30'10"	30'6"	31'6"
Exterior Clearance*	11'2"	11'2"	11'2"	11'2"
Exterior Width	8'4"	8'4"	8'4"	8'4"
Sleeping Capacity**	6	6	6	6
Interior Width	8'	8'	8'	8'
Interior Height	6'6"	6'6"	6'6"	6'6"
Fuel Capacity (gal.)	55	55	55	55
Alternator Amps	130	130	130	130
Fresh Water Capacity (gal.)	30	36	40	40
Waste Water Capacity (gal.)	35	35	35	35
Grey Water Capacity (gal.)	33	33	33	33
Water Heater Capacity (gal.)	6	6	6	6
LP Gas Capacity (lbs.)	85	85	85	85
Furnace Rating (x 1000) BTU	30	30	30	30

Tire Sizes = (1) LT225/75R16E

* Includes clearance for roof A/C ** Front cabover entertainment center options delete one or two sleeping positions.

All information contained in this brochure is believed to be accurate at the time of publication. However, during the model year, it may be necessary to make revisions and Coachmen reserves the right to make all such changes without notice, including changes in prices, colors, materials, equipment and specifications, as well as the addition of new models and the discontinuance of models shown in this brochure. Therefore, please consult with your Coachmen dealer and confirm the existence of any materials, design or specifications that are material to your purchase decision.

GVWR (Gross Vehicle Weight Rating): The maximum permissible weight of the unit, including the UVW plus all fluids, cargo, optional equipment and accessories. For safety and product performance, do not exceed the GVWR.

CW (Curb Weight): The weight of the unit without factory or dealer installed options, plus allowance for the weight of full fuel capacity. The "payload capacity" for all other fluids, cargo, occupants, optional equipment and accessories can be determined by subtracting the CW from the GVWR.

GAWR (Gross Axle Weight Rating): The total weight each front/rear axle, suspension and tire system is designed to carry. When loading the unit, care should be taken to balance cargo weight in consideration of the GAWRs.

GCWR (Gross Combined Weight Rating): The maximum total weight of the loaded unit, plus a tow vehicle. This includes the weight of both the unit and tow vehicle, fuel for each, all other fluids, cargo, occupants, optional equipment and accessories.

Wider Widths: Numerous Coachmen floorplans feature the "wide body" design concept, which gives you significantly enhanced interior living space and innovative floorplans.

In making your purchase decision, you should be aware that a few states restrict access on some or all roads within the state to vehicle with a maximum 96" width, although special road usage permits may be available. Vehicles up to 102" in width are permitted in the vast majority of states. You should confirm the road usage laws in the states of interest to you before making your purchase decision. If width is of concern to you, we invite you to consider the broad array of other Coachmen models offered in the standard 96" width.

IMPORTANT NOTE: All capacities are approximate, and all dimensions are nominal. Coachmen motorhomes are designed to allow for a wide variety of uses, extended trips with two people or short trips with multiple people. Accordingly, each unit allows ample room for sleeping, seating, fluids and cargo. While the customer is the beneficiary of this design, the customer also bears the responsibility to select the proper combination of passengers, cargo, load, and tow vehicle without exceeding the chassis weight capabilities. Consumer may need additional braking capacity to tow loads greater than 1000 pounds.

Seat belts should always be worn for passenger safety. Seat belts are provided at most locations to allow convenience in selecting which seat to occupy. However, it is not intended that all seating positions equipped with a seat belt may be occupied while the vehicle is in motion, without regard to other weight factors.

All Coachmen motorhomes are designed to ensure that the number of passengers allowed while the vehicle is in motion will always at least equal the stated sleeping capacity. Though extra seat belts may be provided, for your safety and the proper operation of your vehicle, limit your passengers to the number allowed by the Net Carrying Capacity of your vehicle.

Quality by Design

Coachmen RV is committed to providing a high quality, reliable, and innovative product. That's why Coachmen designs quality into our products up-front, through computer aided design and analysis software. This helps to assure appropriate weight distributions, structural integrity, alignment of the various parts and components and overall reliability of the design.

Our attention to quality does not stop on the computer screen as all of our major product designs undergo rigorous road tests, rain booth testing, complete compliance audits for all codes, standards and safety related items, and comprehensive product audits.

Coachmen designs, builds and markets a superior product for reasons that may not always be easy to see, however are very easy to appreciate down the road. Our quality equates to high value, which can be critical to your long-term satisfaction.



2005 Class C Motorhomes By Coachmen
 Leporechbaum®

Leprechaun® Standards & Options

Standard Features

INTERIOR APPOINTMENTS

- Ashland Oak Cabinetry
- Mortise & Tenon Hardwood Cabinet Doors
- Residential Metal Drawer Guides
- Techwood Drawer Sides
- Oak Edged Countertops & Dinette Table
- Linoleum (Kitchen, Bath & Entrance Way)
- Night Shades - Coach / Mini Blinds - Bedroom
- Slider Windows w/Safety Glass - (Coach)
- Jalousie Windows w/Safety Glass - (Bedroom)
- Jack Knife Sofa
- Directional Reading Lights Over Sofa
- Booth Dinette
- Reclining Pilot & Passenger Seats
- Laundry Hamper/Chute (Except 292DS)

INTERIOR EQUIPMENT

- AM/FM Stereo w/CD Player
- TV Antenna and Rotor Package
- Cable TV Jacks (Coach & Bedroom)
- TV Cabinet-Bedroom
- Prewired for Satellite Dish
- LP Leak Alarm
- Smoke Detector
- Carbon Monoxide Detector
- Fire Extinguisher

GALLEY

- Residential Size Microwave
- 3-Burner (High Output) Range w/Oven
- Range Cover
- Power, Lighted Range Hood
- Double Door Refrigerator
- Freezer Shelf & Refrigerator Light
- Pull Out Pantry (314SS)
- Monitor Panel
- Stainless Steel Kitchen Sink
- Dedicated Drinking Water Faucet
- Water Purifier
- Silverware Drawer
- Trash Can

SLEEPING

- Cab Over Bunk
- Queen Bed
- Deluxe Innerspring Mattress-312 Coil
- Bedspread & Pillow Shams
- Privacy Drape - Lower Cab
- Privacy Drape - Cab Over
- Accordion Door - Bedroom

BATH AND WATER

- Power Bath Vent
- Foot Pedal Flush Toilet

- One-Piece ABS Tub Surround
- Pump Switch at Termination & Bath
- 6-Gallon Gas/Electric E.I. Water Heater
- Demand Water Pump
- Lavatory Sink
- Medicine Cabinet
- Skylight in Shower
- Towel Bars
- Glass Shower Door

ELECTRICAL/HEATING/ AIR CONDITIONING

- 30- Amp. Power Cord
- 55- Amp. Electronic Converter
- GFI Circuit
- Battery Disconnect
- Auxiliary Battery
- Outside 120V Receptacle (DS)
- Patio Light
- Entrance Stepwell Light
- Dual Coach Battery Compartment
- Exterior Compartment Lights
- 30,000 BTU E.I. Furnace
- Wall Mounted Thermostat
- 13,500 BTU Ducted Roof Air Conditioner
- Generator Ready

AUTOMOTIVE/EXTERIOR

- 55-Gallon Fuel Tank
- Dual Air Bags
- Cruise Control
- Tilt Steering Wheel
- Power Windows and Locks
- Dash Air Conditioning
- Retractable Exterior Mirrors
- Chrome Front Bumper
- Rear Bumper w/Stabilizer Jacks
- Spare Tire Kit
- Laminated Floor & 2" Sidewalls
- Crowned Laminated Rubber Roof
- Full Metal Wheel Covers
- Roof Ladder
- Aluminum Running Boards
- Single Entrance Step
- Rubber Entry Step Tread
- Dead Bolt Lock Entrance Door
- Warehouse Storage (Except 292DS)
- Basement Floor Design
- Radius Entry Door
- Radius Trunk Doors
- Patio Awning



Optional Equipment

□ Deluxe Package - Includes:

- Day/Night Shades - Coach
- Night Shades- Bedroom
- Exterior Entertainment Center
- Deluxe Stereo w/CD, Cassette & Weatherband
- Emergency Start Switch
- Power Entrance Step
- Stainless Steel Wheel Inserts
- Heated Exterior Mirrors w/Remote
- Air Assist Suspension
- Towing Hitch w/7-Way Plug
- Owner's Information Package

□ Premier Package - Includes:

- Deluxe Package Features Plus:
- Rechargeable Flashlight
- Rechargeable Wet/Dry Vacuum
- Coffee Maker
- Hair dryer
- Phone Jack
- Sink Covers
- Fantastic Three-Speed Roof Vent
- Fiberglass Running Boards

□ Residential Dinette w/4 chairs (307KS, 317KS)

- Convection Microwave & 3-Burner Cooktop (IPO Range w/Oven)
- Front Cabover Entertainment Center (24" Flatscreen TV & DVD/VCR Combo)
- Deluxe Front Cabover Entertainment Center (27" Flat Screen TV & DVD/VCR Combo)
- 20" Flat Screen TV - Coach
- DVD/VCR Combo
- Satellite TV System
- Rear Vision Camera
- Grill-2-Go (Except292DS)

□ Front Cabover Window Delete

- Tinted Windows
- 15,000 BTU Ducted Roof Air Conditioner
- 4.0 KW Gas Generator (Quiet Lite)
- Semi-Automatic Leveling Jacks
- Fiberglass Running Boards
- Painted Skirt
- Slide-Out Room Awning - Bedroom (292DS)
- Slide-Out Room Awning- Coach
- CSA Uplift

Construction



Take a Closer Look at Coachmen Quality & Construction

1 Tubular aluminum cage construction of our roof and sidewalls provide great strength without adding unnecessary top-heavy weight - this improves handling and fuel efficiency.

2 All cabinets and tables are mounted to **electro galvanized steel backers** in the sidewalls to stay securely in place.

3 Our **2" sidewalls** are one of the thickest in the Industry. We bond the wall using reactive hot melt urethane lamination with one-piece fiberglass, high-grade Luan backer, block foam insulation, tubular aluminum framing and an interior panel.

4 **Jalousie and slider windows** are combined to offer optimal viewing and ventilation in all weather conditions.

5 We **insulate around every refrigerator** to improve operating efficiency and prolong the trouble free life of the refrigerator.

6 **Exterior storage** has been added wherever possible.

7 **Tubular steel floor framing** provides strength and structural integrity.

8 All **storage areas are water tight sealed** to keep the elements out and your stored gear dry.

9 **Power windows and door locks** are standard features on Leprechaun's.

10 We replaced all the trim parts with **internal sealants** to create a clean, easy to maintain chassis to upfit attachment.

11 We will not build a motorhome with a flat roof! **All roofs are vacuumbond laminated with a crown** for controlled water run-off and additional strength. The roofs are covered with seamless, industrial grade rubber. All roof openings are sealed with butyl rubber based sealants that expand and contract with the climate to help prevent leaks.

12 Coachmen's **Even Cool™ ducted roof air conditioning** provides quiet, cool air that is easily distributed through out the entire motorhome.



By Coachmen



By Coachmen



By Coachmen

Additional Value Added Construction Features:

- Our **Water Works™ Utility Panel** makes filling tanks and draining water lines easy.
- The Coachmen exclusive **No-Mess™ Termination** makes draining waste from your tanks clean and easy.
- All basement models have **heated holding tanks**, valves and controls.
- **Heat reflectors** are installed over the exhaust system to reduce road heat inside the coach.
- **Duratube™ copper LP lines** ensure a tight seal and years of corrosion free use.
- Two year structural and major components warranty, along with the industry's leading full one-year **Coachmen Buckstopper™ Warranty** assures peace of mind.
- Every motorhome is **tested for leaks** in a simulated rain storm created by a rain test lab within the manufacturing plant.

Leprechaun
 2005 Class C Motorhomes By Coachmen

Discover the Coachmen Advantages

Service After the Sale

Industry Leading Buckstopper™ Warranty – Coachmen's exclusive Buckstopper™ Limited Warranty provides one-year coverage on most parts, components and appliances. Coachmen stands behind their product and is supported by a network of over 300 service centers.

Two Year Structural & Major Components Manufacturer's Warranty – Coachmen provides a two-year structural and major components manufacturer's warranty, along with a complete written Warranty Summary Guide, for your peace of mind.

Comprehensive Owner's Information – For your convenience we offer published materials on key equipment and options, as well as information pertaining to the function of important components. We also offer a true **Trouble Shooting and Maintenance Guide** for the simple answers to frequently asked questions.



Toll Free Service Numbers – Our toll free phone numbers provide you with direct access to a Coachmen RV Service Representative.

Dealer Support Tools – Coachmen makes sure that their dealers are well equipped and trained to service your needs with: Systems Manuals, PDI Manuals, Electronic Parts Catalogs, Coach-Link® "On-Line" Electronic Dealer Communication System and continual service training.

Service Support Center Web Site – Coachmen provides you access to key information 24-hours a day through the Internet. On-line you can find a Service Dealer Locator, Maintenance Information, Trouble Shooting Information, Product Warranty Information, Customer "E-Assistance", Frequently Asked Questions (FAQ's) and Publications ordering, dating back to 1972 models.

Priority Parts Ordering – Coachmen provides a program for overnight parts shipment in critical repair situations.

Coachmen Caravan Camping Club™

Coachmen Caravan Camping Club is your ticket to making friends for life. Share old stories and make new, in the company of fellow Coachmen Caravan members. With the purchase of a Coachmen RV, you are invited to join the nation's largest manufacturer sponsored RV club with a **FREE 1st year basic membership or discounted Platinum membership**. As part of the Coachmen Caravan family, you will receive incredible membership benefits that will help to ensure your safety and enjoyment throughout your RV experiences. Enjoy your Coachmen RV more with the Coachmen Caravan Camping Club.



Leader to the Great Outdoors®

Coachmen RV Company is a proven leader in the RV Industry with 40 years of experience. We are dedicated to providing a high quality, reliable and innovative product, backed by high quality service support. Our mission is simple...to meet and exceed your expectations and to make your total RV experiences memorable and enjoyable!



**Coachmen RV Company... A Great Product,
A Great Company, A Great Name!
Coachmen RV Company... Leader to the
Great Outdoors**



Coachmen Recreational Vehicle Company, LLC
P.O. Box 30, Middlebury, IN 46540
P.O. Box 948, Fitzgerald, GA 31750

Visit our website at: www.coachmenrv.com

©2004 Coachmen Recreational Vehicle Company, LLC -
All rights reserved. Litho in USA 7/04



2005 Class C Motorhomes By Coachmen

Leprechaun®