

MONTANA

L U X U R Y F I F T H W H E E L S



WARRANTY FOR
FULL TIME RVING*

*RESIDENCE MUST BE IN COMPANY SERVICE AREA FOR LIMITED WARRANTY STATUS



KEYSTONE
RV COMPANY

LIVE IT OUT.

MONTANA

L U X U R Y F I F T H W H E E L S



WARRANTY FOR
FULL TIME RVING*

*REFERENCE KEYSTONE RV COMPANY OWNERS MANUAL FOR LIMITED WARRANTY DETAILS



KEYSTONE
RV COMPANY

LIVE IT OUT.

MONTANA



MONTANA | LUXURY FIFTH WHEELS

A LIVING LEGACY

Perhaps no other fifth wheel RV inspires its owners like Montana. Built by generations of experienced craftsmen, Montana and Montana High Country are the pinnacle of luxury fifth wheel travel. Stunning interior design, profound attention to detail, and the highest quality materials come together in this collection of unforgettable RV's. With our eyes firmly on the horizon, Montana is driven to deliver innovation that transcends expectations and delights new owners, year after year.

For more information, please visit keystonerv.com/Montana



KEYSTONE EXCLUSIVE INNOVATIONS

Designed to deliver superior performance, quality, and a best-in-class camping experience, every Montana model includes engineering innovations available EXCLUSIVELY to Keystone owners. For more information about these features and the Keystone Innovation Lab, visit us online at www.keystonerv.com/innovations.



KeyTV™

No more connection guesswork or poor reception. KeyTV offers a game-changing, single point of control of over-the-air, cable, and satellite feeds.



Hitch Vision™

Simplifies hitch hook-up with "no looking back*" convenience.



Color-Coded Unified Wiring Standard

Easy-to-trace circuits simplify electrical and entertainment system troubleshooting.



In-floor Heating Ducts

Distributes heat evenly through your coach for superior comfort.



Tuf-Lok™ A/C Duct Joiners

Crush resistant design securely joins ductwork and A/C units, and drastically reduces chilled-air leaks to boost cooling efficiency and comfort.



Tru-fit™ Slide Construction

A more durable slide room design that minimizes functional motor and structural stress and resists leaking.



3-YEAR LIMITED STRUCTURAL WARRANTY, 1-YEAR LIMITED BASE WARRANTY

Every new Keystone RV comes with the industry's best three-year limited structural warranty AND a one-year limited base warranty. Ask your dealer, visit keystonerv.com, or call Keystone Owner Relations for details.

MONTANA



MONTANA | LUXURY FIFTH WHEELS

A LIVING LEGACY

Perhaps no other fifth wheel RV inspires its owners like Montana. Built by generations of experienced craftsmen, Montana and Montana High Country are the pinnacle of luxury fifth wheel travel. Stunning interior design, profound attention to detail, and the highest quality materials come together in this collection of unforgettable RV's. With our eyes firmly on the horizon, Montana is driven to deliver innovation that transcends expectations and delights new owners, year after year.

For more information, please visit keystonerv.com/Montana



KEYSTONE EXCLUSIVE INNOVATIONS

Designed to deliver superior performance, quality, and a best-in-class camping experience, every Montana model includes engineering innovations available EXCLUSIVELY to Keystone owners. For more information about these features and the Keystone Innovation Lab, visit us online at www.keystonerv.com/innovations.



KeyTV™

No more connection guesswork or poor reception. KeyTV offers a game-changing, single point of control of over-the-air, cable, and satellite feeds.



Hitch Vision™

Simplifies hitch hook-up with "no looking back" convenience.



Color-Coded Unified Wiring Standard

Easy-to-trace circuits simplify electrical and entertainment system troubleshooting.



In-floor Heating Ducts

Distributes heat evenly through your coach for superior comfort.

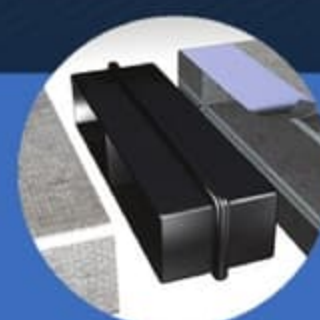

Tuf-Lok™ A/C Duct Joiners

Crush resistant design securely joins ductwork and A/C units, and drastically reduces chilled-air leaks to boost cooling efficiency and comfort.



Tru-fit™ Slide Construction

A more durable slide room design that minimizes functional motor and structural stress and resists leaking.



3-YEAR LIMITED STRUCTURAL WARRANTY, 1-YEAR LIMITED BASE WARRANTY

Every new Keystone RV comes with the industry's best three-year limited structural warranty AND a one-year limited base warranty. Ask your dealer, visit keystonerv.com, or call Keystone Owner Relations for details.



COTTAGE WHITE DECOR

COBBLESTONE DECOR

Bring a truly relaxing feel to your space with cool slate gray leatherette furniture and window treatments. Dovetailed with Montana's Modern Maple cabinetry, Cobblestone provides a scenic path to every great adventure.



COBBLESTONE DECOR



BOURBON DECOR

BOURBON DECOR

Elegant, smooth, and refined, Bourbon décor is a classic choice. The rich brown tones of this furniture add dimension and depth to the Modern Maple cabinetry and refreshingly light flooring.

MONTANA'S COTTAGE WHITE DECOR

Oh-so-on-trend, Montana's Cottage White decor introduces a delightful hand-rubbed painted white finish on the kitchen cabinetry as a cool counterpoint to the Modern Maple featured in the rest of the coach. Cottage White cabinetry accents are offered exclusively with Bourbon furniture.



BOURBON DECOR



COBBLESTONE DECOR



COTTAGE WHITE DECOR

COBBLESTONE DECOR

Bring a truly relaxing feel to your space with cool slate gray leatherette furniture and window treatments. Dovetailed with Montana's Modern Maple cabinetry, Cobblestone provides a scenic path to every great adventure.



COBBLESTONE DECOR



BOURBON DECOR

BOURBON DECOR

Elegant, smooth, and refined, Bourbon décor is a classic choice. The rich brown tones of this furniture add dimension and depth to the Modern Maple cabinetry and refreshingly light flooring.

MONTANA'S COTTAGE WHITE DECOR

Oh-so-on-trend, Montana's Cottage White decor introduces a delightful hand-rubbed painted white finish on the kitchen cabinetry as a cool counterpoint to the Modern Maple featured in the rest of the coach. Cottage White cabinetry accents are offered exclusively with Bourbon furniture.

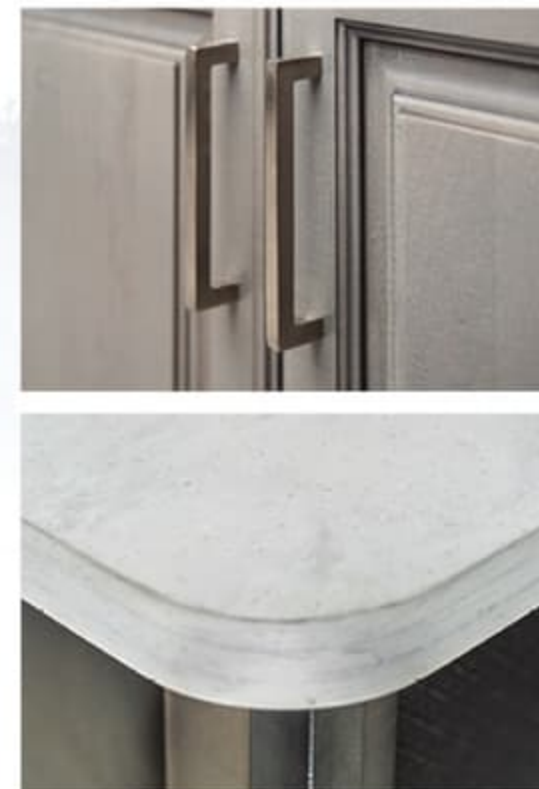

BOURBON DECOR



COBBLESTONE DECOR

OPTIONAL SOLAR FLEX SYSTEM

- Grid Style 300 watt solar panel
- 30 amp MPPT controller
- 2000 watt inverter with 5 inverted electrical outlets: bedroom, refrigerator, kitchen, living area TV and theater seating



OPTIONAL SUPER SOLAR FLEX SYSTEM

- (4) Grid style 300 watt solar panels (1,200 watts total)
- 60 amp MPPT controller
- (2) 275 amp hour Dragonfly Energy LiFePO4 battery bank (550 amp hour total)
- 225 amp Precision Circuits battery guard
- 3000 watt hybrid inverter with every electrical outlet inverted
- 50 amp Precision Circuits energy management system
- (2) 15,000 BTU Power Saver air conditioners with soft start

LEGACY EDITION

OPTIONAL PACKAGE INCLUDES:

- Dexter® Disc brakes
- Generator prep
- Surge protection
- Furrion® Vision S™ side and rear view cameras
- Electric power cord reel
- Rear fiberglass cap (n/a 3760, 3761, 3762, 3763, 3790, 3791)
- iN-Command® Control System with Global Connect



COBALT FULL BODY PAINT

MODERN AMENITIES

Montana is driven to deliver innovation and craftsmanship that will delight owners, year after year.

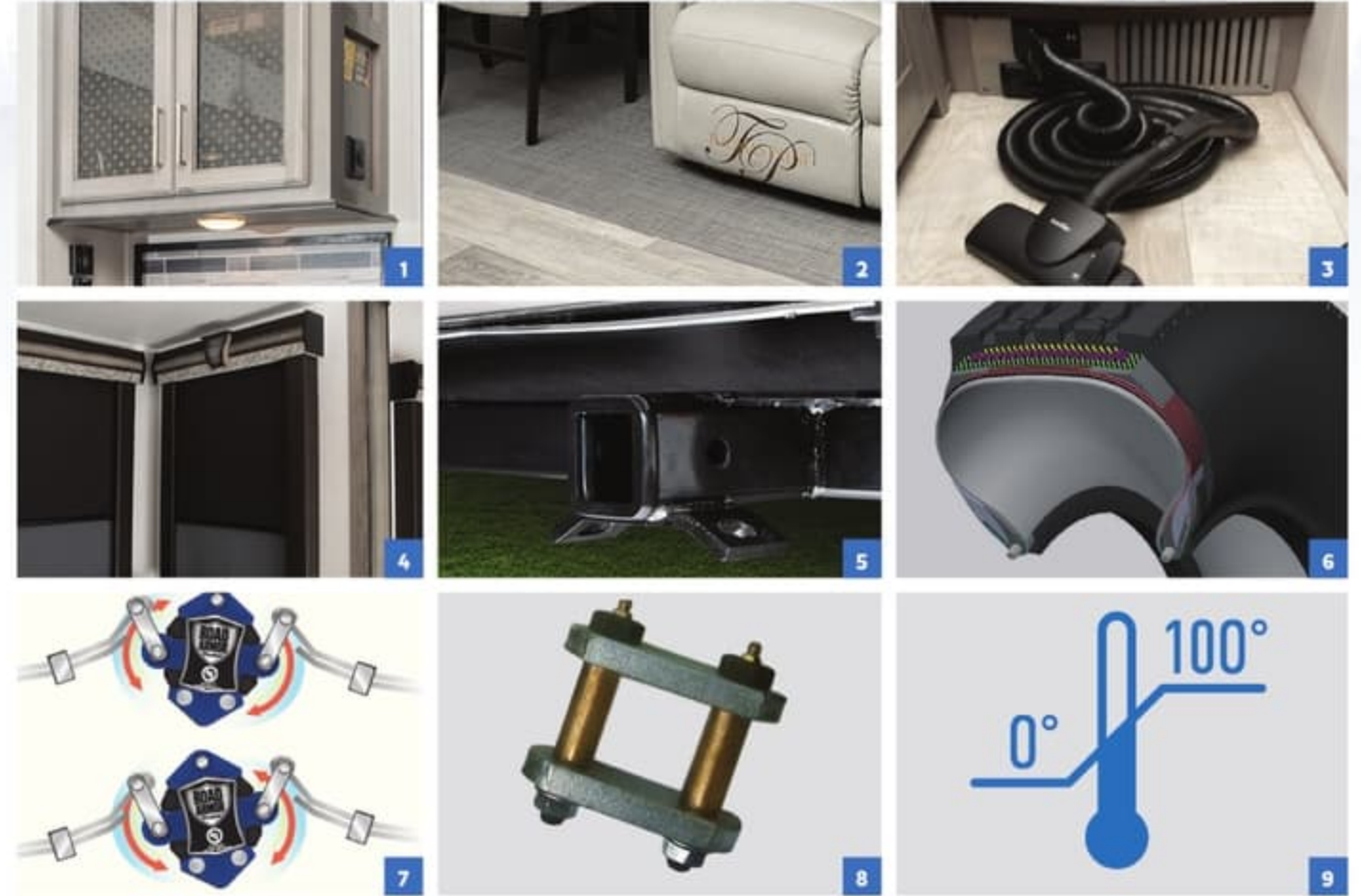

1. SOLID HARDWOOD CABINET STILES
Lasting elegance that won't peel or fade.

2. WOVEN FLOORING WITH RESIDENTIAL BASEBOARDS IN SLIDEOUT
This highly durable marine-grade flooring eliminates carpet and makes cleaning a breeze.

3. INDOOR/OUTDOOR CENTRAL VACUUM
Clean up your coach in a snap with this convenient tool

4. DAY/NIGHT ROLLER SHADES
Dual shades allow you to control light and privacy levels at any time.

5. 2" TOWING HITCH N/A 3760/3761, 3762/3762, 3790/3791
Allows you to tow your watercraft behind your RV (up to 3,000 lb).

6. SAILUN G-RATED TIRES W/ 6-YEAR WARRANTY
Premium higher ply tires safely allow higher driving speeds and carrying capacity.

7. EXCLUSIVE ROAD ARMOR™ SUSPENSION / 360° VIBRATION CONTROL
Equalizes axle load to dampen shock and vibration.

8. WET BOLTS & HEAVY DUTY SHACKLE PLATES
Greaseable wet bolts reduce friction and improve the life of your suspension system.

9. FOUR SEASON CAMPING
Camp to 0°F without water lines or tanks freezing.

DÉCOR OPTIONS



COBBLESTONE

BOURBON

COTTAGE WHITE

OPTIONAL SOLAR FLEX SYSTEM

- Grid Style 300 watt solar panel
- 30 amp MPPT controller
- 2000 watt inverter with 5 inverted electrical outlets: bedroom, refrigerator, kitchen, living area TV and theater seating



OPTIONAL SUPER SOLAR FLEX SYSTEM

- (4) Grid style 300 watt solar panels (1,200 watts total)
- 60 amp MPPT controller
- (2) 275 amp hour Dragonfly Energy LiFePO4 battery bank (550 amp hour total)
- 225 amp Precision Circuits battery guard
- 3000 watt hybrid inverter with every electrical outlet inverted
- 50 amp Precision Circuits energy management system
- (2) 15,000 BTU Power Saver air conditioners with soft start

LEGACY EDITION

OPTIONAL PACKAGE INCLUDES:

- Dexter® Disc brakes
- Generator prep
- Surge protection
- Furrion® Vision S™ side and rear view cameras
- Electric power cord reel
- Rear fiberglass cap (n/a 3760, 3761, 3762, 3763, 3790, 3791)
- iN-Command® Control System with Global Connect



COBALT FULL BODY PAINT

MODERN AMENITIES

Montana is driven to deliver innovation and craftsmanship that will delight owners, year after year.

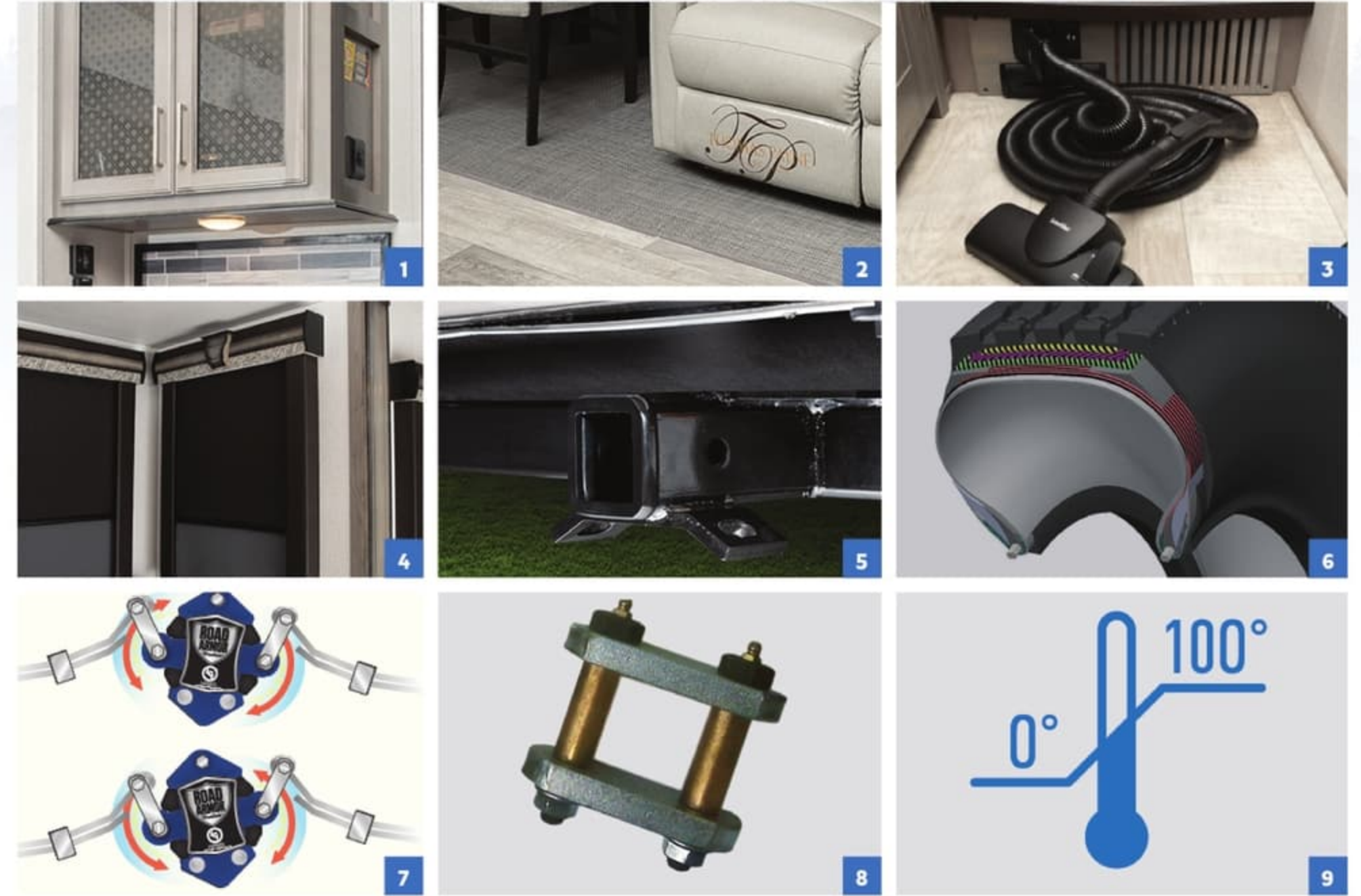

1. SOLID HARDWOOD CABINET STILES
Lasting elegance that won't peel or fade.

2. WOVEN FLOORING WITH RESIDENTIAL BASEBOARDS IN SLIDEOUT
This highly durable marine-grade flooring eliminates carpet and makes cleaning a breeze.

3. INDOOR/OUTDOOR CENTRAL VACUUM
Clean up your coach in a snap with this convenient tool

4. DAY/NIGHT ROLLER SHADES
Dual shades allow you to control light and privacy levels at any time.

5. 2" TOWING HITCH N/A 3760/3761, 3762/3762, 3790/3791
Allows you to tow your watercraft behind your RV (up to 3,000 lb).

6. SAILUN G-RATED TIRES W/ 6-YEAR WARRANTY
Premium higher ply tires safely allow higher driving speeds and carrying capacity.

7. EXCLUSIVE ROAD ARMOR™ SUSPENSION / 360° VIBRATION CONTROL
Equalizes axle load to dampen shock and vibration.

8. WET BOLTS & HEAVY DUTY SHACKLE PLATES
Greaseable wet bolts reduce friction and improve the life of your suspension system.

9. FOUR SEASON CAMPING
Camp to 0°F without water lines or tanks freezing.

DÉCOR OPTIONS



COBBLESTONE

BOURBON

COTTAGE WHITE

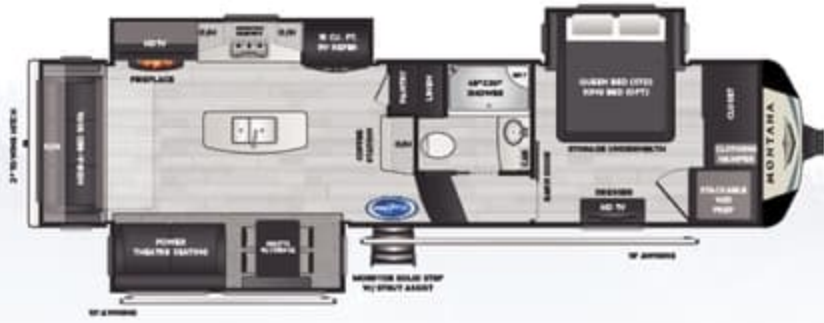

3120/3121RL | Rear living room, three slides
 W/ REFRIGERATOR RES. REFRIGERATOR
 WEIGHT:12056 LENGTH:35'



TOP 10 2021 RV **NEW! 3230/3231CK** | Center kitchen, three slides, dual vanity
 W/ REFRIGERATOR RES. REFRIGERATOR
 WEIGHT:12955 LENGTH:37' 5"

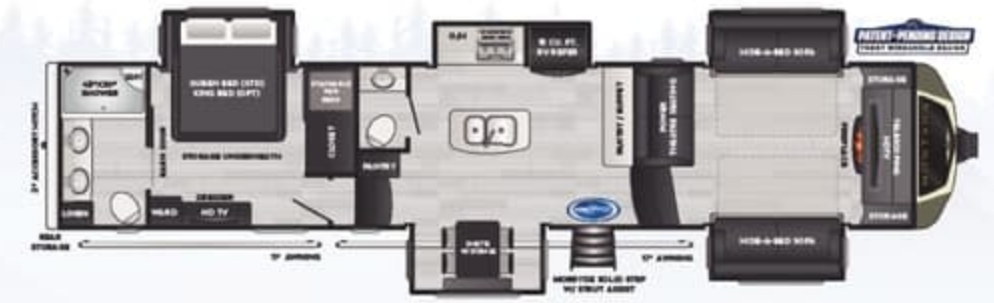

3760/3761FL | Front living, five slides, 1 1/2 baths
 W/ REFRIGERATOR RES. REFRIGERATOR
 WEIGHT:14147 LENGTH:41'



NEW! 3762/3763BP | Front living w/ butler's pantry, five slides
 W/ REFRIGERATOR RES. REFRIGERATOR
 WEIGHT:14065 LENGTH:41'

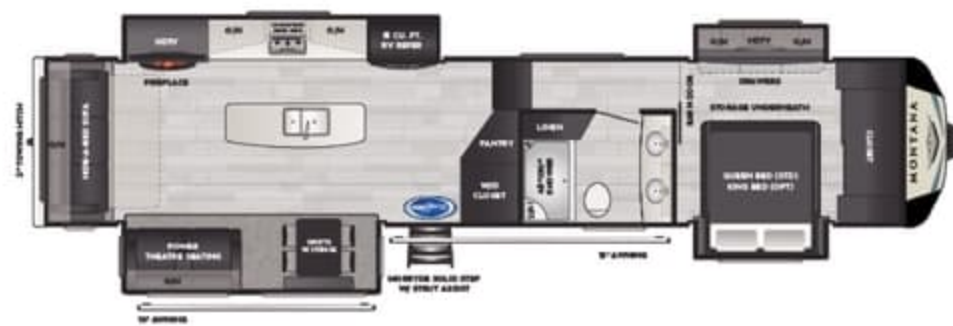

3780/3781RL | Rear living w/ double vanity bathroom & double slide bedroom
 W/ REFRIGERATOR RES. REFRIGERATOR
 WEIGHT:13490 LENGTH:41'



3790/3791RD | Elevated rear den w/ rear pull-out storage
 W/ REFRIGERATOR RES. REFRIGERATOR
 WEIGHT:14119 LENGTH:40' 5"



3812/3813MS | Rear living room w/ master suite & walk-in closet
 W/ REFRIGERATOR RES. REFRIGERATOR
 WEIGHT:13635 LENGTH:40' 9"

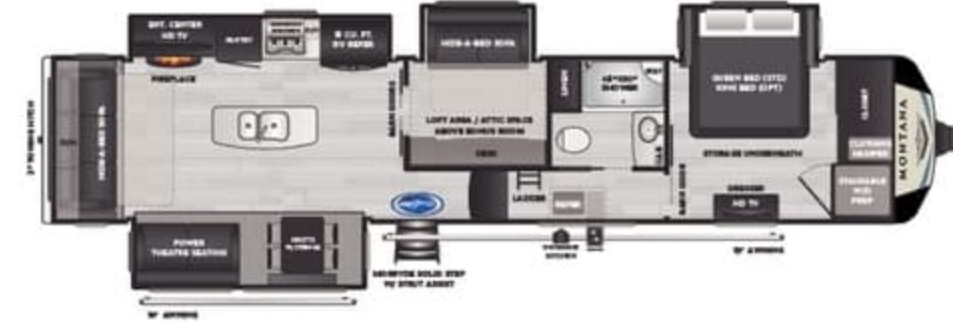

3854/3855BR | Bonus room w/ loft and outside kitchen
 W/ REFRIGERATOR RES. REFRIGERATOR
 WEIGHT:13644 LENGTH:40' 11"

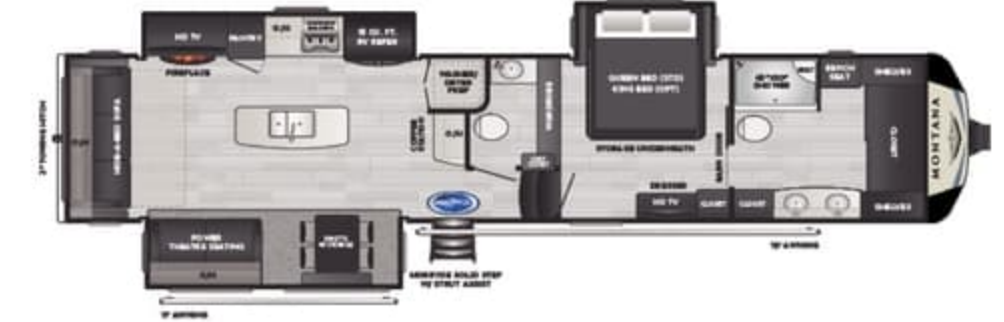

3930/3931FB | Front bathroom w/ front wardrobe
 W/ REFRIGERATOR RES. REFRIGERATOR
 WEIGHT:13564 LENGTH:41' 4"

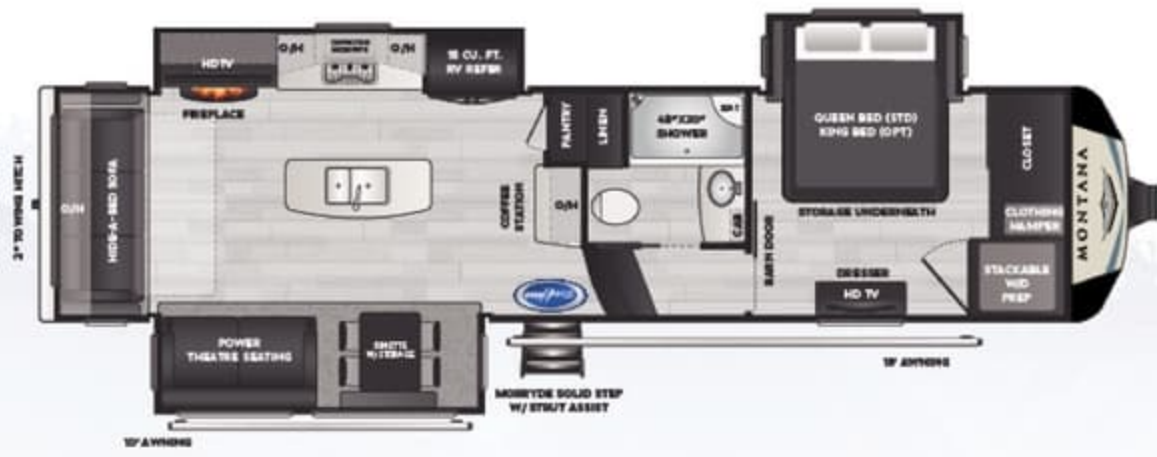

3120/3121RL | Rear living room, three slides
RV REFRIGERATOR RES. REFRIGERATOR
WEIGHT:12056 LENGTH:35'

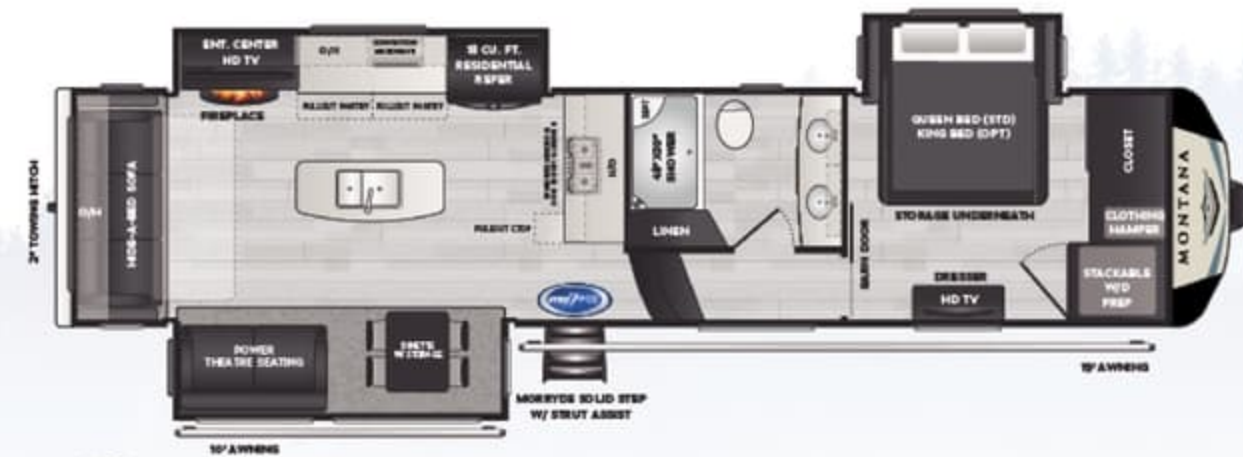

TOP 10 2021 RV **NEW! 3230/3231CK** | Center kitchen, three slides, dual vanity
RV REFRIGERATOR RES. REFRIGERATOR
WEIGHT:12955 LENGTH:37' 5"

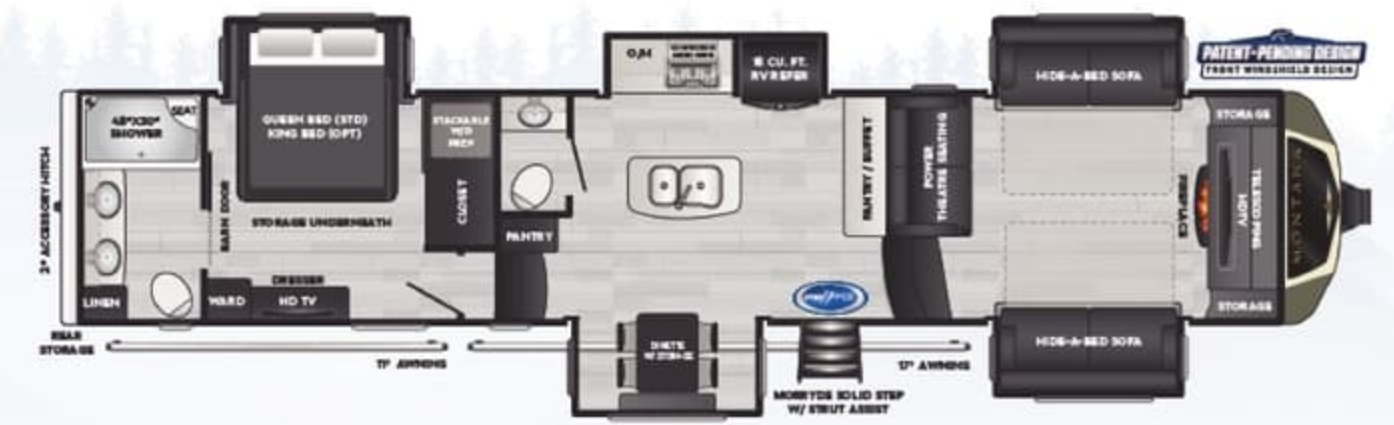

3760/3761FL | Front living, five slides, 1 1/2 baths
RV REFRIGERATOR RES. REFRIGERATOR
WEIGHT:14147 LENGTH:41'

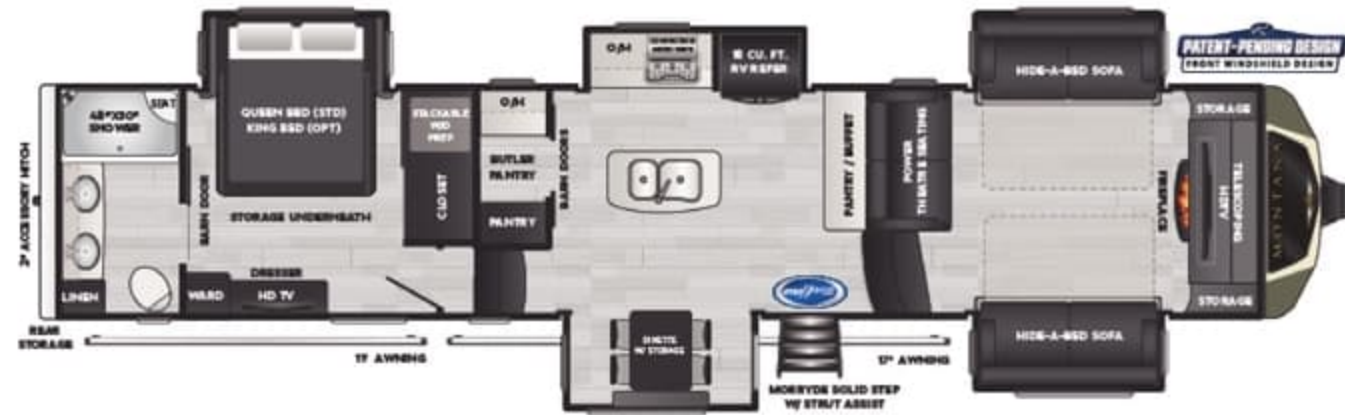

NEW! 3762/3763BP | Front living w/ butler's pantry, five slides
RV REFRIGERATOR RES. REFRIGERATOR
WEIGHT:14065 LENGTH:41'

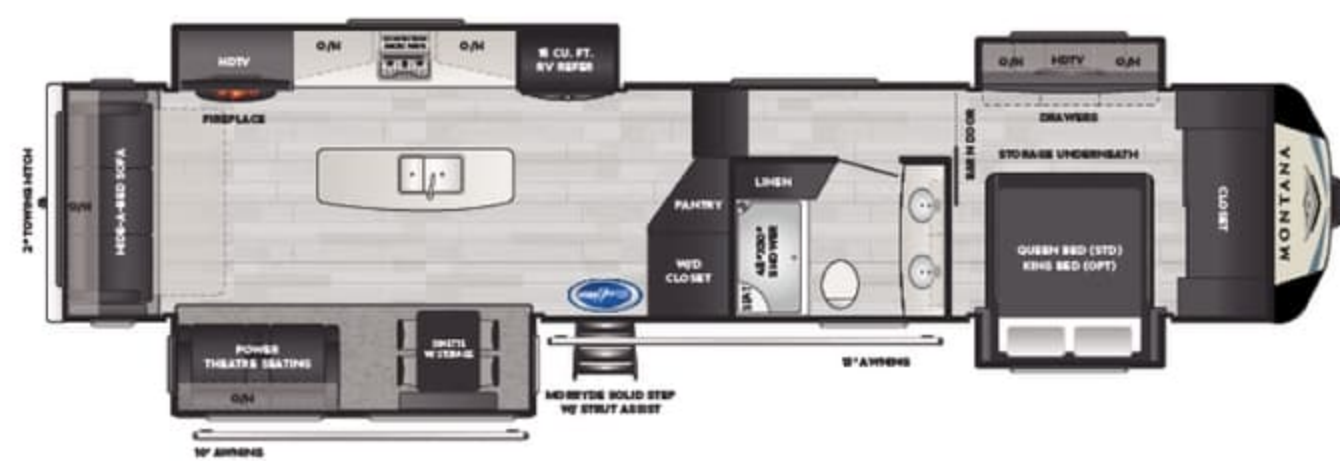

3780/3781RL | Rear living w/ double vanity bathroom & double slide bedroom
RV REFRIGERATOR RES. REFRIGERATOR
WEIGHT:13490 LENGTH:41'

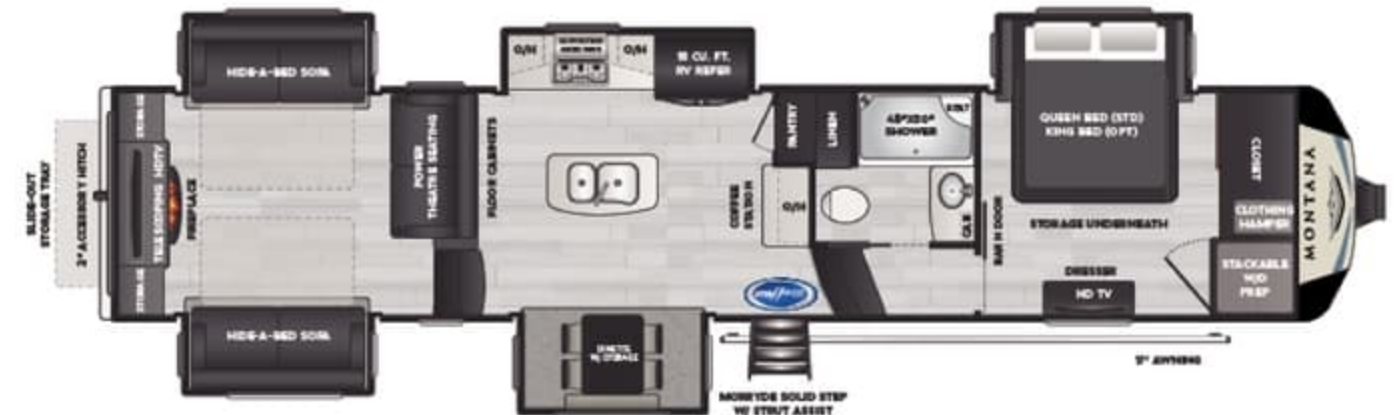

3790/3791RD | Elevated rear den w/ rear pull-out storage
RV REFRIGERATOR RES. REFRIGERATOR
WEIGHT:14119 LENGTH:40' 5"

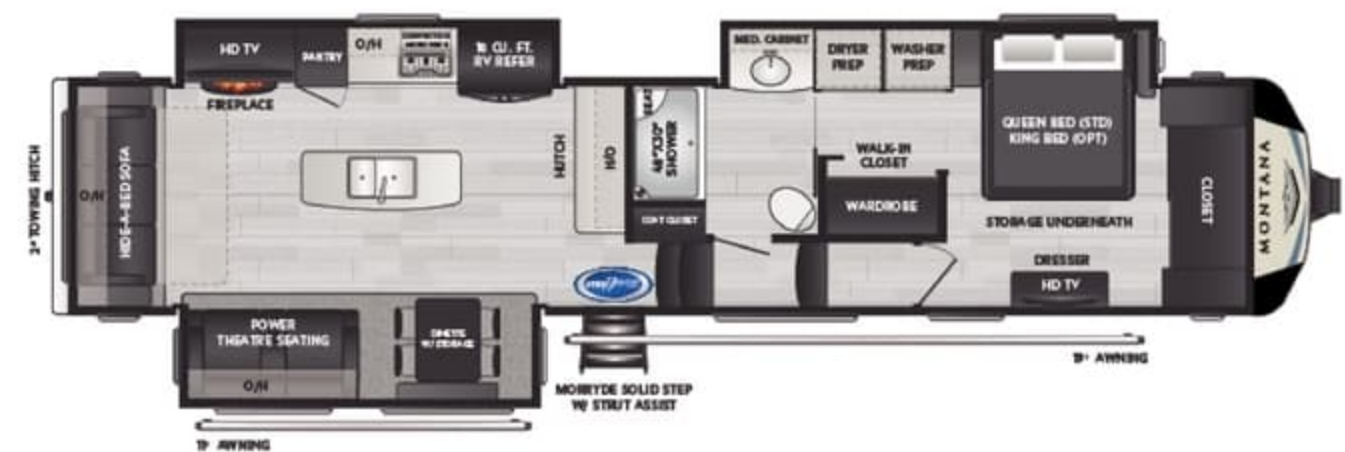

3812/3813MS | Rear living room w/ master suite & walk-in closet
RV REFRIGERATOR RES. REFRIGERATOR
WEIGHT:13635 LENGTH:40' 9"

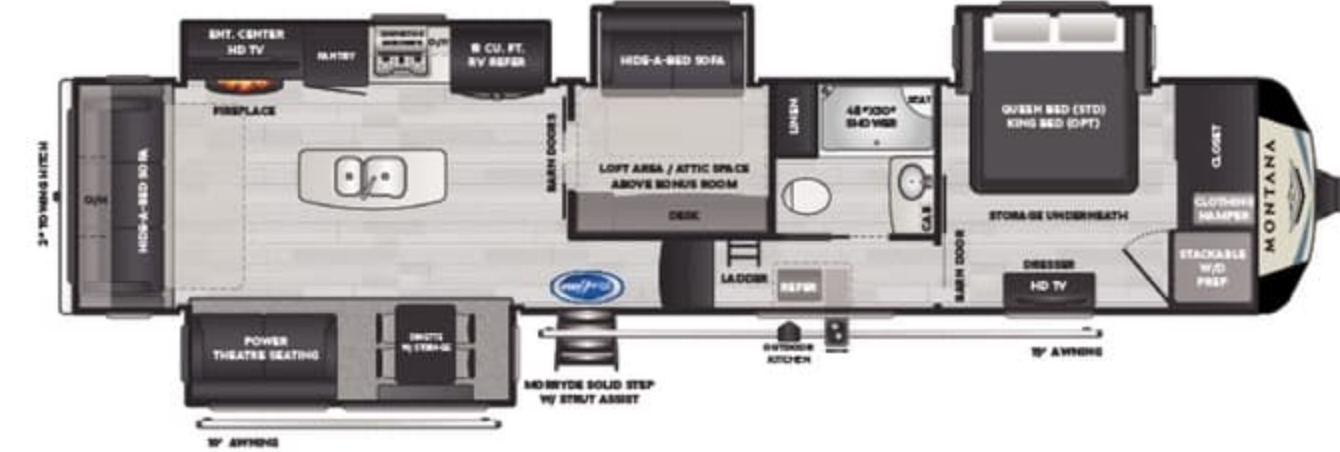

3854/3855BR | Bonus room w/ loft and outside kitchen
RV REFRIGERATOR RES. REFRIGERATOR
WEIGHT:13644 LENGTH:40' 11"

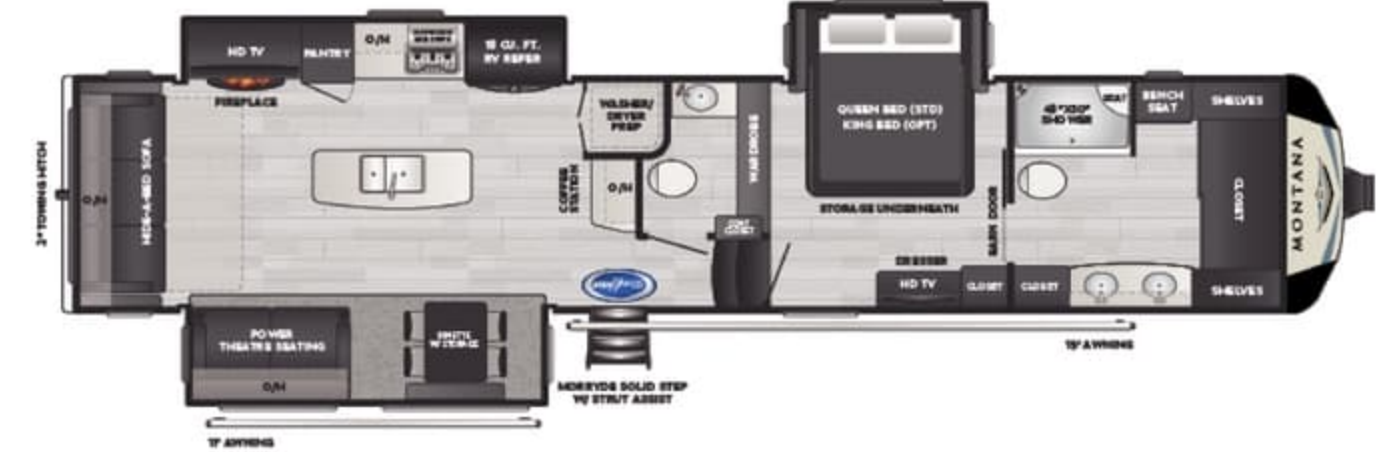

3930/3931FB | Front bathroom w/ front wardrobe
RV REFRIGERATOR RES. REFRIGERATOR
WEIGHT:13564 LENGTH:41' 4"

MODEL	WEIGHT	CARRYING CAPACITY	HITCH WEIGHT	FRESH WATER	WASTE WATER	GRAY WATER	LPG	LENGTH*	WIDTH	HEIGHT	AWNING
3120RL	12056	3944	2280	66	49	88	60	35' 0"	8'	13' 4"	16'/10'
3121RL	11999	4351	2350	66	49	88	60	35' 0"	8'	13' 4"	16'/10'
3230CK	12955	3725	2680	66	49	88	60	37' 5"	8'	13' 4"	19'/10'
3231CK	12955	3725	2680	66	49	88	60	37' 5"	8'	13' 4"	19'/10'
3760FL	14147	2653	2880	66	88	88	60	41' 0"	8'	13' 4"	17'/11'
3761FL	14147	2653	2880	66	88	88	60	41' 0"	8'	13' 4"	17'/11'
3762BP	14065	2915	2980	66	49	88	60	41' 0"	8'	13' 4"	17'/11'
3763BP	14065	2915	2980	66	49	88	60	41' 0"	8'	13' 4"	17'/11'
3780RL	13490	3110	2695	66	49	88	60	41' 0"	8'	13' 4"	13'/11'
3781RL	13490	3110	2695	66	49	88	60	41' 0"	8'	13' 4"	13'/11'
3790RD	14119	2481	2600	66	49	88	60	40' 5"	8'	13' 4"	17'
3791RD	14119	2481	2620	66	49	88	60	40' 5"	8'	13' 4"	17'
3812MS	13635	3165	2820	66	49	88	60	40' 9"	8'	13' 4"	19'/11'
3813MS	13635	3165	2820	66	49	88	60	40' 9"	8'	13' 4"	19'/11'
3854BR	13576	3324	2940	66	49	88	60	40' 11"	8'	13' 4"	16'/10'
3855BR	13644	3256	2940	66	49	88	60	40' 11"	8'	13' 4"	16'/10'
3930FB	13564	2936	2550	66	88	88	60	41' 4"	8'	13' 4"	19'/11'
3931FB	13542	2958	2530	66	88	88	60	41' 4"	8'	13' 4"	19'/11'

DISCLAIMER: Product information is as accurate as possible as of the date of publication of this brochure. All features, floor plans, and specifications in this brochure are subject to change without notice. Please also consult Keystone's web site at www.keystonecv.com for more current product information and specifications. Tow Vehicle Disclaimer: CAUTION: Owners of Keystone recreational vehicles are solely responsible for the selection and proper use of tow vehicles. All customers should consult with a motor vehicle manufacturer or their dealer concerning the purchase and use of suitable tow vehicles for Keystone products. Keystone disclaims any liability or damages suffered as a result of the selection, operation, use or misuse of a tow vehicle. KEYSTONE'S LIMITED WARRANTY DOES NOT COVER DAMAGE TO THE RECREATIONAL VEHICLE OR THE TOW VEHICLE AS A RESULT OF THE SELECTION, OPERATION, USE OR MISUSE OF THE TOW VEHICLE. *Length is defined as the distance from the centerline of hitch pin/ coupler to rear bumper of trailer. Please review owner's manual prior to purchase for more information on service warranties, extended use, towing and maintenance. Owner's manuals can be found at keystonecv.com.

MONTANA | STANDARDS & OPTIONS

LIVING AREA FEATURES

- Thomas Payne Collection® theater seating w/ electric recliners, massage, and seat warmers (Modern Maple Edition)
- Thomas Payne Collection® tri-fold hide-a-bed sofa(s) (Modern Maple Edition)
- Backlit crown molding (Modern Maple Edition)
- Craftsman style slide-out fascia (Modern Maple Edition)
- Handcrafted window valance center blocks (Modern Maple Edition)
- Midnight roller shades with reflective back side and solar screen day shades (Modern Maple Edition)
- Residential baseboards (Modern Maple Edition)
- Beaufort® Heartwood resilient vinyl flooring (Modern Maple Edition)
- Syntec® Jubilation woven PVC flooring (Modern Maple Edition)
- Brushed nickel heat vents (Modern Maple Edition)
- Living room privacy curtain: 3760/3761FL, 3762/3763BP, 3790/3791RD (Modern Maple Edition)
- LED dimmer switches in select areas (Modern Maple Edition)
- Flush-mounted LED interior lights
- LED motion sensor light at steps

KITCHEN FEATURES

- Modern Maple cabinetry w/ hand wiped glazing (Modern Maple Edition)
- Soft-close hidden cabinet hinges
- Hardwood cabinet framing (Modern Maple Edition)
- Modern Maple hardwood kitchen island panels w/ backlit double diamond glass inserts (Modern Maple Edition)
- Modern subway backsplash (Modern Maple Edition)
- 35" x 12" or 48" x 12" kitchen window behind cook top (Modern Maple Edition)
- MJ Finishing wall-mounted, free standing dinette w/ flip leaf (Modern Maple Edition)
- Two (2) fixed and two (2) folding dinette chairs
- Chair Buddy® to secure dinette chairs
- Pop-up electrical and USB outlets tower in free standing dinette buffet cabinet
- 18 cu. ft. 4-door RV refrigerator (3120RL, 3230CK, 3760FL, 3762BP, 3780RL, 3790RD, 3812MS, 3854BR, 3930FB)

6E® French door residential refrigerator w/ ice maker, filtered water, and 2000 watt inverter (3121RL, 3231CK, 3761FL, 3763BP, 3781RL, 3791RD, 3813MS, 3855BR, 3931FB)

- Soft-close full extension drawer guides
- Pull out kitchen trash can (select models)
- Solid surface kitchen countertops (Residential Living Package)
- Solid surface flush-mount sink covers (Residential Living Package)
- Sink cover storage below kitchen sink (Residential Living Package)
- Motion sensor LED lighting below kitchen sink
- LED accent lighting below kitchen countertops
- Motion sensor LED light in pantry (select models)
- Deep 60/40 stainless steel sink (Residential Living Package)
- High-rise faucet with integrated pull out sprayer (Residential Living Package)
- 30" over-the-range convection/microwave oven (Residential Living Package)
- Suburban® Elite Series 22" gas cook top and oven w/ bi-fold glass cover
- Central vacuum w/ interior and exterior ports plus toe-kick sweep (Residential Living Package)
- Power vent fan w/ rain sensor (Four Season Living Package)

HOME ENTERTAINMENT

- Jensen® DVD/CD/MP3 entertainment system w/ Bluetooth®
- Marine-grade exterior speakers
- Patented KeyTV® satellite prep (Residential Living Package)
- Wiigard Air 360+ Amplified omni-directional antenna, roof satellite connection, and 4G LTE / Wi-Fi prep (Residential Living Package)
- Jensen® 50" HD LED TV in living area (Residential Living Package)
- Jensen® 32" HD LED TV in bedroom (Residential Living Package)

BEDROOM FEATURES

- Residential bedspread and pillows (Modern Maple Edition)
- 3 Square Ombre Black headboard (Modern Maple Edition)
- 48" x 12" bedroom window above headboard (Modern Maple Edition)

Renovo Sleep® memory foam mattress w/ Fera® ice cover (Modern Maple Edition)

- 60" x 80" queen bed
- Reading lights over bed
- Storage under bed
- Wood TV cabinet
- Two (2) bedside electrical outlets (Residential Living Package)
- Bedside night stands (Residential Living Package)
- Prepped for combo or stackable washer/dryer w/ separate 20 Amp circuits for each appliance (Residential Living Package)
- Barn door w/ magnetic latch
- Motion sensor LED light in bedroom closet
- Laundry hamper (select models)
- Six drawer extra capacity dresser
- Folding dinette chair storage in washer/dryer closet

BATHROOM FEATURES

- Sandstone natural molded bathroom vanity top w/ stainless steel sink (Modern Maple Edition)
- Dometic 310 ceramic toilet with PowerFlush technology (Modern Maple Edition)
- Sliding bathroom door (select models)
- Skylight over shower (Four Season Living Package)
- 12-gallon DSI gas/electric water heater (Four Season Living Package)
- Three (3) Drawers one (1) door vanity
- Brushed nickel shower head and faucet
- Seamless 48" x 30" fiberglass shower
- 50 Amp service (Residential Living Package)
- 75 Amp converter w/ Charge Wizard technology and battery selector: lead acid / lithium (Residential Living Package)
- Power vent fan w/ rain sensor (Four Season Living Package)
- Motion sensor LED lighting in linen storage cabinet (select models)

CONSTRUCTION FEATURES

- Unified wiring standard: each wire color-coded and numbered
- 5" arched roof rafters
- Welded aluminum framed walls and floors
- CNC routed, laminated sidewalls w/ dual layered luan and metal backing strips to anchor interior cabinets
- Seamless 5/8" thick floor decking
- Powder coated 12" steel I-beam frame
- Seamless roto-cast holding tanks
- Double-insulated laminated rear wall

FOUR SEASON FEATURES

- 35,000 BTU Furnace (Four Season Living Package)
- 3" x 14" in-floor straight line heat duct system (Four Season Living Package)
- Coleman Mach® power saver 15,000 BTU Whisper Quiet main air conditioner system, bedroom (Four Season Living Package)
- Coleman Mach® power saver 15,000 BTU Whisper Quiet main air conditioner system, living room (Four Season Living Package)
- Wired and framed for 3rd air conditioner (Four Season Living Package)
- 16,500 BTU heat pump on main air conditioner (Four Season Living Package)
- Tested and approved for 0° usage (Four Season Living Package)
- Two attic vents for cross-ventilation (Four Season Living Package)
- Insulated and heated holding tanks and dump valves (Four Season Living Package)
- Insulated in-floor water lines (Four Season Living Package)
- Enclosed and heated low point drains (Four Season Living Package)
- 12V electric tank heaters (Four Season Living Package)
- 12V ceiling fan w/ wall controls (select models) (Four Season Living Package)
- 48" LED fireplace (Four Season Living Package)

TOWING FEATURES

- Max Turn Technology® front cap and radius frame
- Hitch Vision® mirror
- Road Armor® pin box
- Prepped for rear and side view cameras
- Road Armor® suspension w/ 360° vibration control
- Sailen G-range tires with 6-year manufacturer warranty
- Heavy duty wet bolt kit with bronze bushings and 1/2" shackle links
- 16" 8-lug aluminum wheels (110 PSI)
- 7000 lb Dexter Gladiator® thick-wall axles w/ upgraded springs and Nev-R-Adjust® brakes
- Super-Brite LED taillights with back-up lights
- LED marker lights
- Undermount spare tire and carrier

EXTERIOR FEATURES

- KeyShield™ automotive-grade paint on front cap
- High-gloss gel coated sidewalls and rear wall
- Automotive frameless safety glass windows
- LPG quick-connect for accessories
- Extra large fold away entry handle
- Rear roof ladder
- Roof mounted solar prep (wired for 5 interior inverted outlets)
- Slam latch pass-through storage compartment doors
- Extra large (30" wide by 76" tall) entry door w/ friction hinge (Residential Living Package)
- Entry door w/ Screen Shot® and Screen Defender®
- Drop-frame pass-through storage compartment (Residential Living Package)
- MO'Ryde® Step Above® entry steps w/ strut assist (Residential Living Package)
- Motion sensor LED lights in pass-through storage compartment
- LED safety light package: entry step, gooseneck, upper slide-outs, and sewer termination
- LED off door side scare light

EASY SET-UP FEATURES

- Dometic 12V electric patio awning w/ LED lights and Power Channel
- Second 12V electric patio awning w/ LED lights and Power Channel (select models)
- Heated central exterior water and convenience center: (outside shower w/ quick-connect hose, black tank flush, easy winterization kit, water heater bypass, power tank fill, enclosed low point drains, battery disconnect, KeyTV® hook-ups, 12V motion sensor light)

OPTIONS

- Modern Maple Edition Package (mandatory option)
- Residential Living Package (mandatory option)
- Four Season Living Package (mandatory option)
- 6-point Hydraulic Leveling System (mandatory option)
- 2" Towing Hitch: 3120/3121RL, 3230/3231CK, 3780/3781RL, 3812/3813MS, 3854/3855BR, 3930/3931FB (mandatory option)
- 2" Accessory Hitch: 3760/3761FL, 3762/3763BP, 3790/3791RD (mandatory option)
- Legacy Edition Package w/ generator ready
- Full Body Paint (Requires Legacy Edition Package)
- Dual pane frameless windows
- King bed
- Outdoor kitchen (N/A 3760/3761FL, 3762/3763BP, 3854/3855BR)
- Solar Flex™ system
- Super Solar Flex™ system
- Generator ready
- Onan Marquis Gold 5.5 KW LP generator
- Slide-out awnings package

MODEL	WEIGHT	CARRYING CAPACITY	HITCH WEIGHT	FRESH WATER	WASTE WATER	GRAY WATER	LPG	LENGTH*	WIDTH	HEIGHT	AWNING
3120RL	12056	3944	2280	66	49	88	60	35' 0"	8'	13' 4"	16'/10'
3121RL	11999	4351	2350	66	49	88	60	35' 0"	8'	13' 4"	16'/10'
3230CK	12955	3725	2680	66	49	88	60	37' 5"	8'	13' 4"	19'/10'
3231CK	12955	3725	2680	66	49	88	60	37' 5"	8'	13' 4"	19'/10'
3760FL	14147	2653	2880	66	88	88	60	41' 0"	8'	13' 4"	17'/11'
3761FL	14147	2653	2880	66	88	88	60	41' 0"	8'	13' 4"	17'/11'
3762BP	14065	2915	2980	66	49	88	60	41' 0"	8'	13' 4"	17'/11'
3763BP	14065	2915	2980	66	49	88	60	41' 0"	8'	13' 4"	17'/11'
3780RL	13490	3110	2695	66	49	88	60	41' 0"	8'	13' 4"	13'/11'
3781RL	13490	3110	2695	66	49	88	60	41' 0"	8'	13' 4"	13'/11'
3790RD	14119	2481	2600	66	49	88	60	40' 5"	8'	13' 4"	17'
3791RD	14119	2481	2620	66	49	88	60	40' 5"	8'	13' 4"	17'
3812MS	13635	3165	2820	66	49	88	60	40' 9"	8'	13' 4"	19'/11'
3813MS	13635	3165	2820	66	49	88	60	40' 9"	8'	13' 4"	19'/11'
3854BR	13576	3324	2940	66	49	88	60	40' 11"	8'	13' 4"	16'/10'
3855BR	13644	3256	2940	66	49	88	60	40' 11"	8'	13' 4"	16'/10'
3930FB	13564	2936	2550	66	88	88	60	41' 4"	8'	13' 4"	19'/11'
3931FB	13542	2958	2530	66	88	88	60	41' 4"	8'	13' 4"	19'/11'

DISCLAIMER: Product information is as accurate as possible as of the date of publication of this brochure. All features, floor plans, and specifications in this brochure are subject to change without notice. Please also consult Keystone's web site at www.keystonerv.com for more current product information and specifications. Tow Vehicle Disclaimer. CAUTION: Owners of Keystone recreational vehicles are solely responsible for the selection and proper use of tow vehicles. All customers should consult with a motor vehicle manufacturer or their dealer concerning the purchase and use of suitable tow vehicles for Keystone products. Keystone disclaims any liability or damages suffered as a result of the selection, operation, use or misuse of a tow vehicle. KEYSTONE'S LIMITED WARRANTY DOES NOT COVER DAMAGE TO THE RECREATIONAL VEHICLE OR THE TOW VEHICLE AS A RESULT OF THE SELECTION, OPERATION, USE OR MISUSE OF THE TOW VEHICLE. *Length is defined as the distance from the centerline of hitch pin/coupler to rear bumper of trailer. Please review owner's manual prior to purchase for more information on service warranties, extended use, towing and maintenance. Owner's manuals can be found at keystonerv.com.

MONTANA | STANDARDS & OPTIONS

LIVING AREA FEATURES
Thomas Payne Collection® theater seating w/ electric recliners, massage, and seat warmers (Modern Maple Edition)
Thomas Payne Collection® tri-fold hide-a-bed sofa(s) (Modern Maple Edition)
Backlit crown molding (Modern Maple Edition)
Craftsman style slide-out fascia (Modern Maple Edition)
Handcrafted window valance center blocks (Modern Maple Edition)
Midnight roller shades with reflective back side and solar screen day shades (Modern Maple Edition)
Residential baseboards (Modern Maple Edition)
Beaufort® Heartwood resilient vinyl flooring (Modern Maple Edition)
Syntec® Jubilation woven PVC flooring (Modern Maple Edition)
Brushed nickel heat vents (Modern Maple Edition)
Living room privacy curtain: 3760/3761FL, 3762/3763BP, 3790/3791RD (Modern Maple Edition)
LED dimmer switches in select areas (Modern Maple Edition)
Flush-mounted LED interior lights
LED motion sensor light at steps
KITCHEN FEATURES
Modern Maple cabinetry w/ hand wiped glazing (Modern Maple Edition)
Soft-close hidden cabinet hinges
Hardwood cabinet framing (Modern Maple Edition)
Modern Maple hardwood kitchen island panels w/ backlit double diamond glass inserts (Modern Maple Edition)
Modern subway backsplash (Modern Maple Edition)
35" x 12" or 48" x 12" kitchen window behind cook top (Modern Maple Edition)
MJ Finishing wall-mounted, free standing dinette w/ flip leaf (Modern Maple Edition)
Two (2) fixed and two (2) folding dinette chairs
Chair Buddy® to secure dinette chairs
Pop-up electrical and USB outlets tower in free standing dinette buffet cabinet
18 cu. ft. 4-door RV refrigerator (3120RL, 3230CK, 3760FL, 3762BP, 3780RL, 3790RD, 3812MS, 3854BR, 3930FB)

GE® French door residential refrigerator w/ ice maker, filtered water, and 2000 watt inverter (3121RL, 3231CK, 3761FL, 3763BP, 3781RL, 3791RD, 3813MS, 3855BR, 3931FB)
Soft-close full extension drawer guides
Pull out kitchen trash can (select models)
Solid surface kitchen countertops (Residential Living Package)
Solid surface flush-mount sink covers (Residential Living Package)
Sink cover storage below kitchen sink (Residential Living Package)
Motion sensor LED lighting below kitchen sink
LED accent lighting below kitchen countertops
Motion sensor LED light in pantry (select models)
Deep 60/40 stainless steel sink (Residential Living Package)
High-rise faucet with integrated pull out sprayer (Residential Living Package)
30" over-the-range convection/microwave oven (Residential Living Package)
Suburban® Elite Series 22" gas cook top and oven w/ bi-fold glass cover
Central vacuum w/ interior and exterior ports plus toe-kick sweep (Residential Living Package)
Power vent fan w/ rain sensor (Four Season Living Package)
HOME ENTERTAINMENT
Jensen® DVD/CD/MP3 entertainment system w/ Bluetooth®
Marine-grade exterior speakers
Patented KeyTV® satellite prep (Residential Living Package)
Winegard Air 360+ Amplified omni-directional antenna, roof satellite connection, and 4G LTE / Wi-Fi prep (Residential Living Package)
Jensen® 50" HD LED TV in living area (Residential Living Package)
Jensen® 32" HD LED TV in bedroom (Residential Living Package)
BEDROOM FEATURES
Residential bedspread and pillows (Modern Maple Edition)
3 Square Ombre Black headboard (Modern Maple Edition)
48" x 12" bedroom window above headboard (Modern Maple Edition)

Renovo Sleep® memory foam mattress w/ Feran Ice cover (Modern Maple Edition)
60" x 80" queen bed
Reading lights over bed
Storage under bed
Wood TV cabinet
Two (2) bedside electrical outlets (Residential Living Package)
Bedside night stands (Residential Living Package)
Prepped for combo or stackable washer/dryer w/ separate 20 Amp circuits for each appliance (Residential Living Package)
Barn door w/ magnetic latch
Motion sensor LED light in bedroom closet
Laundry hamper (select models)
Six drawer extra capacity dresser
Folding dinette chair storage in washer/dryer closet
BATHROOM FEATURES
Sandstone natural molded bathroom vanity top w/ stainless steel sink (Modern Maple Edition)
Dometic 310 ceramic toilet with PowerFlush technology (Modern Maple Edition)
Sliding bathroom door (select models)
Skylight over shower (Four Season Living Package)
12-gallon DSI gas/electric water heater (Four Season Living Package)
Three (3) Drawers one (1) door vanity
Brushed nickel shower head and faucet
Seamless 48" x 30" fiberglass shower
50 Amp service (Residential Living Package)
75 Amp converter w/ Charge Wizard technology and battery selector: lead acid / lithium (Residential Living Package)
Power vent fan w/ rain sensor (Four Season Living Package)
Motion sensor LED lighting in linen storage cabinet (select models)
CONSTRUCTION FEATURES
Unified wiring standard: each wire color-coded and numbered
5" arched roof rafters
Welded aluminum framed walls and floors
CNC routed, laminated sidewalls w/ dual layered lauan and metal backing strips to anchor interior cabinets
Seamless 5/8" thick floor decking
Powder coated 12" steel I-beam frame
Seamless roto-cast holding tanks
Double-insulated laminated rear wall
FOUR SEASON FEATURES
35,000 BTU Furnace (Four Season Living Package)
3"x14" in-floor straight line heat duct system (Four Season Living Package)
Coleman Mach® power saver 15,000 BTU Whisper Quiet main air conditioner system, bedroom (Four Season Living Package)
Coleman Mach® power saver 15,000 BTU Whisper Quiet main air conditioner system, living room (Four Season Living Package)
Wired and framed for 3rd air conditioner (Four Season Living Package)
16,500 BTU heat pump on main air conditioner (Four Season Living Package)
Tested and approved for 0° usage (Four Season Living Package)
Two attic vents for cross-ventilation (Four Season Living Package)
Insulated and heated holding tanks and dump valves (Four Season Living Package)
Insulated in-floor water lines (Four Season Living Package)
Enclosed and heated low point drains (Four Season Living Package)
12V electric tank heaters (Four Season Living Package)
12V ceiling fan w/ wall controls (select models) (Four Season Living Package)
48" LED fireplace (Four Season Living Package)

TOWING FEATURES
Max Turn Technology® front cap and radius frame
Hitch Vision® mirror
Road Armor® pin box
Prepped for rear and side view cameras
Road Armor® suspension w/ 360° vibration control
Sailun G-range tires with 6-year manufacturer warranty
Heavy duty wet bolt kit with bronze bushings and 1/2" shackle links
16" 8-lug aluminum wheels (110 PSI)
7000 lb Dexter Gladiator® thick-wall axles w/ upgraded springs and Nev-R-Adjust® brakes
Super-Brite LED taillights with back-up lights
LED marker lights
Undermount spare tire and carrier
EXTERIOR FEATURES
KeyShield™ automotive-grade paint on front cap
High-gloss gel coated sidewalls and rear wall
Automotive frameless safety glass windows
LPG quick-connect for accessories
Extra large fold away entry handle
Rear roof ladder
Roof mounted solar prep (wired for 5 interior inverted outlets)
Slam latch pass-through storage compartment doors
Extra large (30" wide by 78" tall) entry door w/ friction hinge (Residential Living Package)
Entry door w/ Screen Shot® and Screen Defender®
Drop-frame pass-through storage compartment (Residential Living Package)
MOryde® Step Above® entry steps w/ strut assist (Residential Living Package)
Motion sensor LED lights in pass-through storage compartment
LED safety light package: entry step, gooseneck, upper slide-outs, and sewer termination
LED off door side scare light
EASY SET-UP FEATURES
Dometic 12V electric patio awning w/ LED lights and Power Channel
Second 12V electric patio awning w/ LED lights and Power Channel (select models)
Heated central exterior water and convenience center: (outside shower w/ quick-connect hose, black tank flush, easy winterization kit, water heater bypass, power tank fill, enclosed low point drains, battery disconnect, KeyTV® hook-ups, 12V motion sensor light)
OPTIONS
Modern Maple Edition Package (mandatory option)
Residential Living Package (mandatory option)
Four Season Living Package (mandatory option)
6-point Hydraulic Leveling System (mandatory option)
2" Towing Hitch: 3120/3121RL, 3230/3231CK, 3780/3781RL, 3812/3813MS, 3854/3855BR, 3930/3931FB (mandatory option)
2" Accessory Hitch: 3760/3761FL, 3762/3763BP, 3790/3791RD (mandatory option)
Legacy Edition Package w/ generator ready
Full Body Paint (Requires Legacy Edition Package)
Dual pane frameless windows
King bed
Outdoor kitchen (N/A 3760/3761FL, 3762/3763BP, 3854/3855BR)
Solar Flex® system
Super Solar Flex™ system
Generator ready
Onan Marquis Gold 5.5 KW LP generator
Slide-out awnings package

BUILT FOR THE LONG HAUL



1 EASIER SHOPPING.

At Keystone, we make choosing an RV as easy as finding the Big Dipper on a dark summer night. With comprehensive online product information, Key Connect™ product advisors, and an unparalleled dealer network, we will help you select the perfect RV for your family's adventure.

2 INNOVATIVE THINKING.

The road's a nicer place when you have the industry's smartest features behind you. Keystone leads the pack in patented innovations that make our RVs safer, more comfortable, and easier to operate.

3 LONG HAUL QUALITY.

To keep you on the road, there are certain things we just won't build a Keystone RV without. Game-changing features like our Unified Wiring Standard, Tru-Fit™ five-point slide construction, and no-fall Tuf-Lok™ A/C duct joiners combined with exhaustive testing and inspections are some of the reasons why Keystone is able to offer our owners the industry's best 3-year limited structural warranty.

4 WORRY-FREE CUSTOMER SERVICE.

Wherever the road takes you, you're never too far from an authorized Keystone service center. We also offer live service assistance, ultra-fast parts shipping, online maintenance tips and tricks, and a single-point warranty claims policy. *That's* peace of mind.

5 KEYSTONE NATION.

When you choose Keystone, you become a part of one of the largest camping families in the country. We're Keystone Nation. A friendly community where people share photos, travel tips and amazing stories — all in the spirit of camaraderie and adventure. Come join us.

BUILT FOR THE LONG HAUL



1 EASIER SHOPPING.

At Keystone, we make choosing an RV as easy as finding the Big Dipper on a dark summer night. With comprehensive online product information, Key Connect™ product advisors, and an unparalleled dealer network, we will help you select the perfect RV for your family's adventure.

2 INNOVATIVE THINKING.

The road's a nicer place when you have the industry's smartest features behind you. Keystone leads the pack in patented innovations that make our RVs safer, more comfortable, and easier to operate.

3 LONG HAUL QUALITY.

To keep you on the road, there are certain things we just won't build a Keystone RV without. Game-changing features like our Unified Wiring Standard, Tru-Fit™ five-point slide construction, and no-fail Tuf-Lok™ A/C duct joiners combined with exhaustive testing and inspections are some of the reasons why Keystone is able to offer our owners the industry's best 3-year limited structural warranty.

4 WORRY-FREE CUSTOMER SERVICE.

Wherever the road takes you, you're never too far from an authorized Keystone service center. We also offer live service assistance, ultra-fast parts shipping, online maintenance tips and tricks, and a single-point warranty claims policy. *That's* peace of mind.

5 KEYSTONE NATION.

When you choose Keystone, you become a part of one of the largest camping families in the country. We're Keystone Nation. A friendly community where people share photos, travel tips and amazing stories — all in the spirit of camaraderie and adventure. Come join us.